



PE

SUPERSTRUCTURE



PE

FLOAT

## PBM18

### Minimum maintenance

Our PBM18 polyethylene buoys are designed for both sheltered and open-sea waters. These buoys are characterised by their minimum maintenance.

### Rotomoulded polyethylene

Made from high-quality rotomoulded virgin polyethylene, filled with closed-cell expanded polyurethane foam. Polyethylene includes the necessary pigment that provides the colour. UV filters guarantee a stable colour protection during their whole service life. Structural reinforcement bars from the mooring eyes to the lifting eyes are included.

### Long service life

Manufactured with high-quality and resistant materials, these buoys provide a long service life under harsh marine conditions.



Region A

## FEATURES

- High-shock resistant float manufactured with rotomoulded virgin polyethylene, 12 mm thickness. Other thicknesses available under request.
- Float filled with closed-cell expanded polyurethane foam, in order to avoid water absorption.
- Possibility of integrated ballast weight for a greater stability.
- Lifting eyes, mooring eyes and accessories from stainless steel.
- Colour impregnated in the polyethylene.
- Chromaticity according to IALA Recommendations.
- UV protection.
- Compatible with a large variety of self-contained and marine LED lanterns.
- Top mark to increase buoy conspicuity at daytime.
- Minimum maintenance.
- Designed according to IALA Recommendations.
- Structural reinforcement bars between mooring eyes and lifting eyes.

# PBM18

	(D) Float diameter	(A) Focal Height	(FH) Float Height	(C) Draft	(H) Total height	Float Volume	Total weight	Max. chain
<b>PBM18-1</b>	1.8 m	2.1 m	1.8 m	0.7 m	3.8 m	2.3 m <sup>3</sup>	545 Kg	770 Kg
<b>PBM18-2</b>	1.8 m	2.6 m	1.8 m	0.7 m	4.3 m	2.3 m <sup>3</sup>	565 Kg	770 Kg
<b>PBM18-3</b>	1.8 m	3.1 m	1.8 m	0.7 m	4.8 m	2.3 m <sup>3</sup>	585 Kg	770 Kg

*\*Other volumes and heights available under request.*

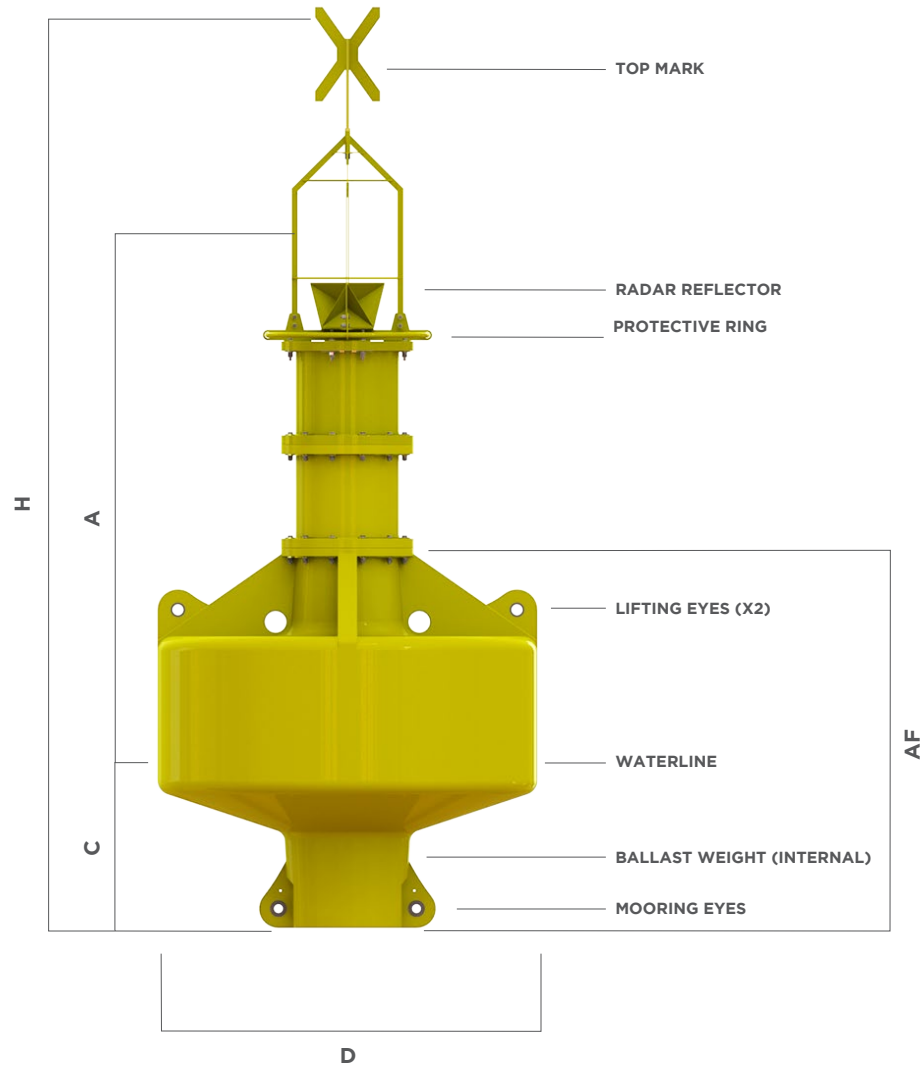

# PBM18

## Versions

PBM18 - 1 LEVEL

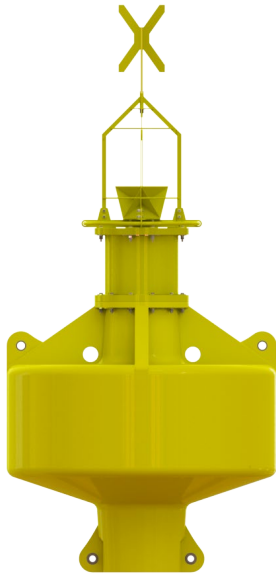

PBM18 - 2 LEVELS

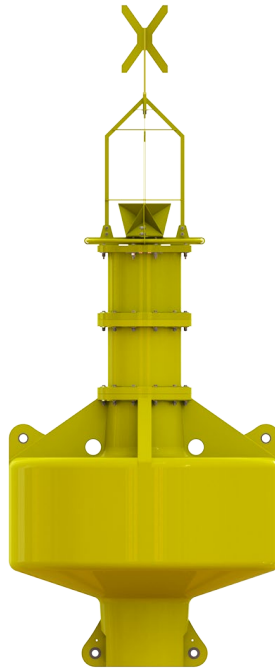

PBM18 - 3 LEVELS

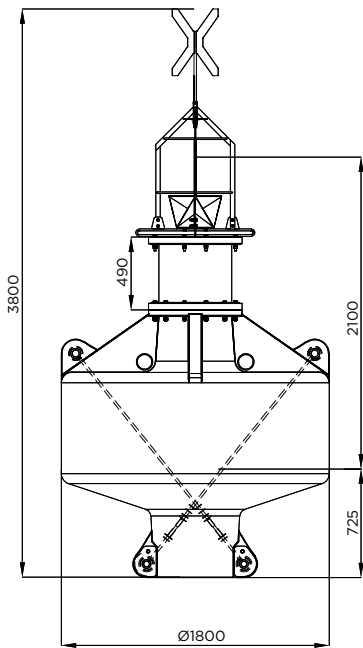
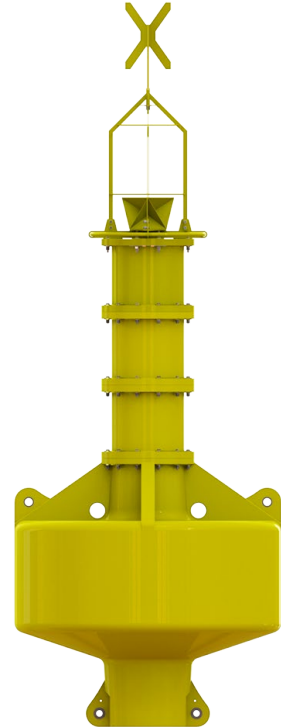

==== Internal metallic reinforcements.

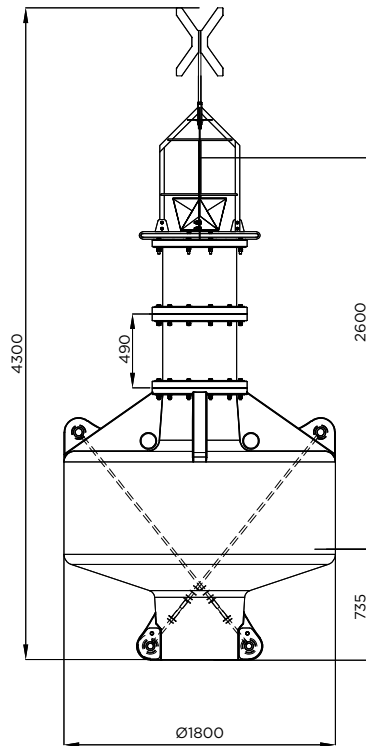

==== Internal metallic reinforcements.

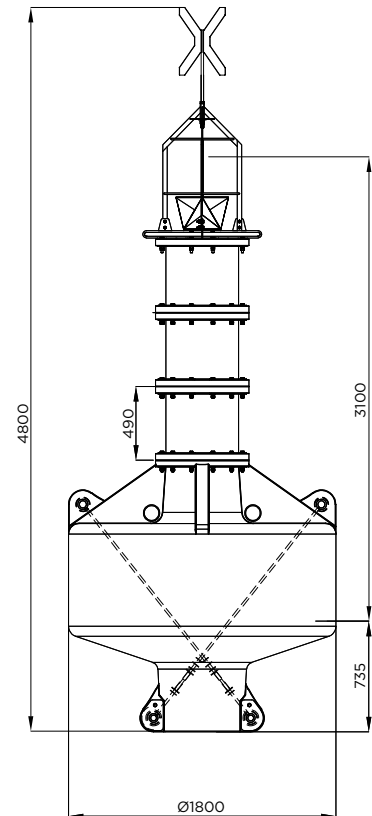

==== Internal metallic reinforcements.

# PBM18

---

## Superestructura

---

<b>Material:</b>	Rotomoulded polyethylene.
<b>Top mark:</b>	Stainless-steel, according to IALA Recommendations.
<b>Radar reflector:</b>	10 m <sup>2</sup> (X Band).
<b>Lifting eyes:</b>	2 nos. from stainless-steel.
<b>Hardware:</b>	Stainless-steel.

## Float

---

<b>Diameter:</b>	1.8 metres.
<b>Material:</b>	12 mm thickness rotomoulded polyethylene.
<b>Filling:</b>	Closed-cell expanded polyurethane foam.
<b>Top Surface:</b>	Anti-sliding.
<b>Ballast weight:</b>	Concrete, internal.

## Options

---

- High-visibility day marks.
- Expanded polystyrene float filling.
- Passive radar reflector up to 36 m<sup>2</sup> RCS available.
- Active radar reflector.
- Other thickness available under request.



Specifications subject to change without previous notice.

